

CROSS SECTION

B-B'

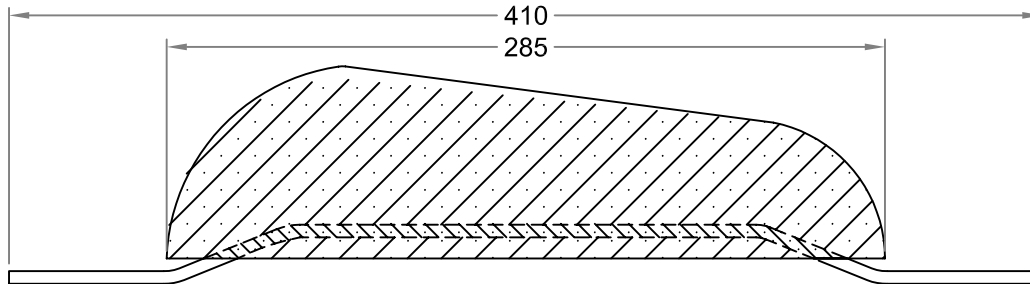

CROSS SECTION

A-A'

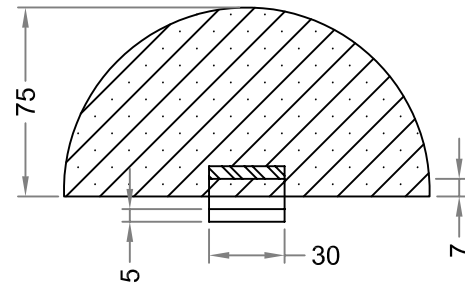

NOTES:

- 1.Net Weight: 4,3 Kg
- 2.Gross weight: 4,8 Kg
- 3.Insert Weight: 0.5 Kg

4.Insert quality:  
Plate,bar sections:EN10025  
grade S235 or S275

5.Insert Welding  
All fabrication of steel  
insert are accoring EN10287  
and EN10288

6. All dimensions are in mm



No	DATE	REVISION	REV	CHK	APP

DRAWING NAME:

ANODE GENERAL DESCRIPTION

ANODE TYPE:

A43

DESIGNED	ND	BELONGS	
STUDIED	ND	PAGE	1
APPROVED	SP	SCALE	1/3
DRAWING NUMBER	DATE	28/9/2009	
A43-285-145-75	CODE		